

Illustration

Keep these instructions for future reference.

Brake Fluid Tester

OT-200

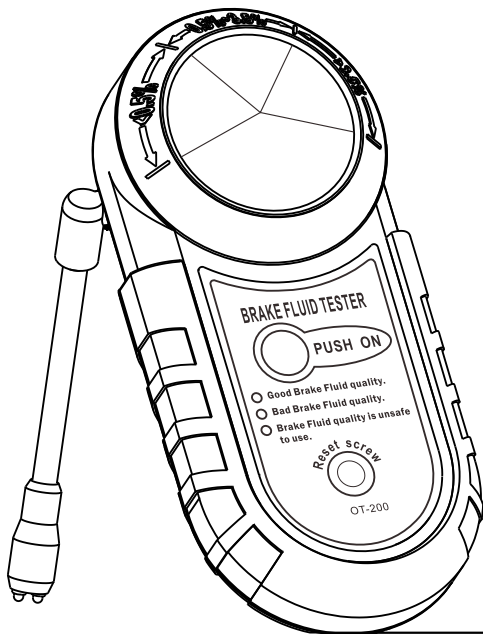

DC-9V Battery
not included.

Contents

English.....	3~8
--------------	-----

- Use the tester as quick reference to the moisture content of the brake fluid.
- L.E.D. read out indicates quality of brake fluid.

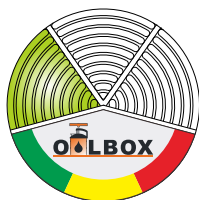

Indicates good
Brake Fluid quality.

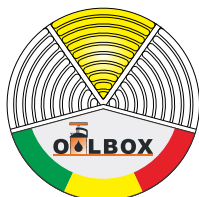

Indicates bad
Brake Fluid quality.

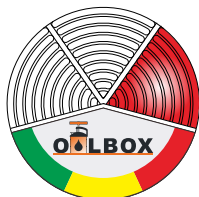

Indicates Brake Fluid
quality is unsafe to use.

SPARE PARTS

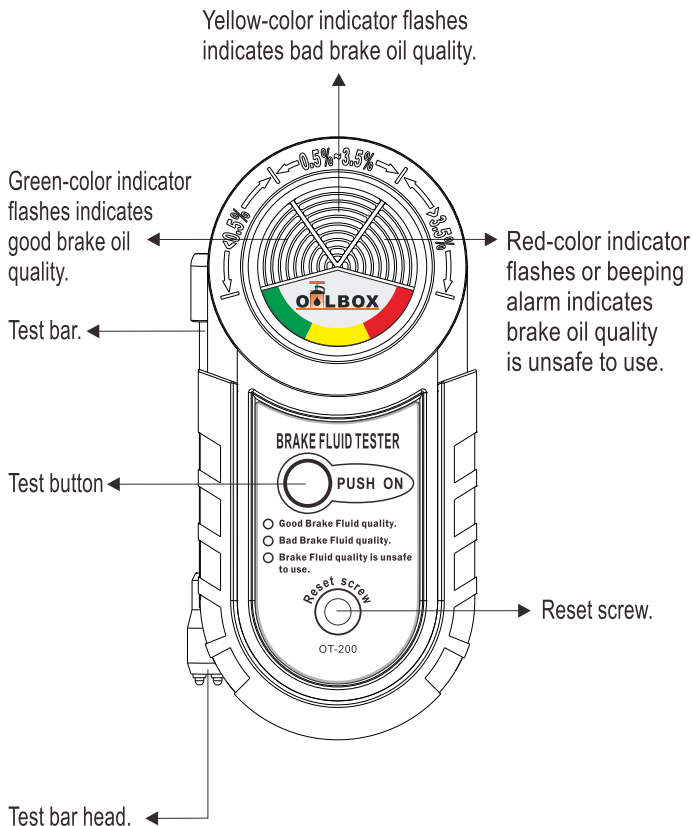

Install the battery

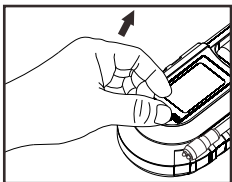

1. Open the battery box.

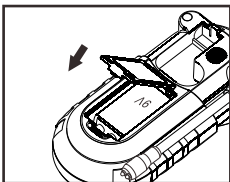

2. Put into a 9V battery to the battery seat.

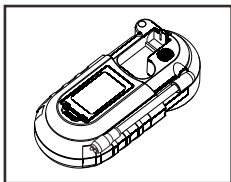

3. Close the battery box.

CALIBRATION INSTRUCTIONS

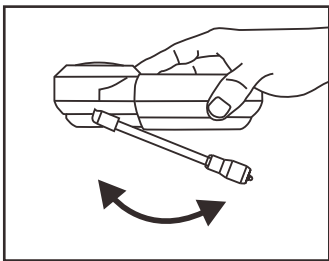

1. Unfold test bar.

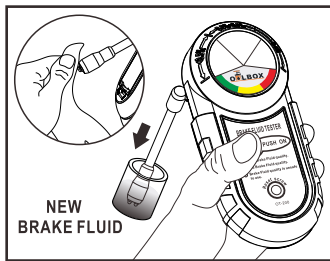

2. Clean 2 probes on test bar head.

Dip test bar head in new brake fluid drawn from a previously unopened container.

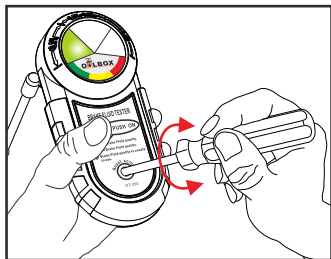

3. Press test button and the other hand use a crosshead screwdriver to adjust trim screw anticlockwise to the end at same time. Meanwhile, all lights are off. Then adjust the screw clockwise until the green light lights up, and the setting is finish.

OPERATING INSTRUCTIONS

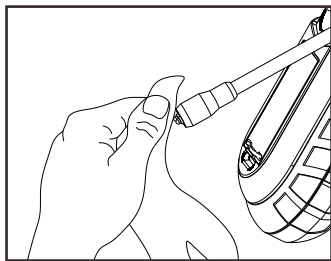

1. Clean the two electric poles of the test bar head.

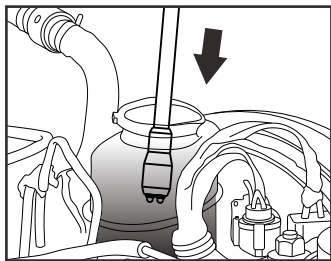

2. Dip the test bar head into the brake oil tank 2cm deep to check the condition of the old brake oil.

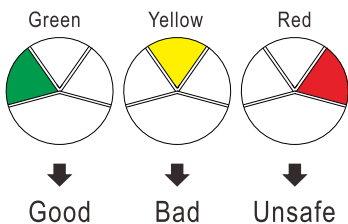
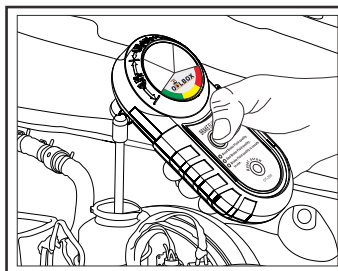

3. Push the test button in order to view the oil condition indicators.

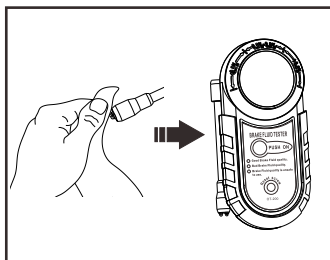

4. After completion, clean the electric poles again and replace the test bar to the original location.

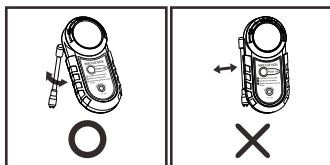

※ The test bar is forbidden using and bending improperly. If there's any damage without normal usage, we are not responsible for this. <as Fig.>

CAUTION

- ※ Please wipe the sensor before using in order to avoid the reduction of accuracy.
 - ※ Please use 9V batteries. Please take out the battery when not using for a long time.
 - ※ Reset the instrument after different kinds of new oil testing.
 - ※ When the light keeps flashing and cannot be operated, it's a reminding to replace the battery.
 - ※ This instrument is mainly meant for **DOT-4**.
Using other numbers of brake fluid is for reference only.
 - ※ After pressing the test button, red, yellow, green light would light up with a beeping sound together at same time. It's a detection movement before testing.
-

Application

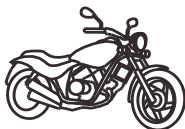

Moto-bike



Automobile